

LEASEHOLD



Apartment

COOPERS CLOSE, DAGENHAM, RM10 8TQ

Guide Price

£175,000

FEATURES

- Guide Price - £175,000 - £200,000
- ***CHAIN FREE***
- First Floor Apartment
- One Bedroom
- Lounge
- Fitted Kitchen
- Bathroom
- Electric Heating



STEPS

Estate Agents

1 Bedroom Apartment located in Dagenham

Entrance

Via communal security door. Communal staircase to first floor. Private door to

Hallway

Electric storage heater. Built in airing cupboard housing hot water cylinder.
Doors to

Lounge

15'5" x 10'1"

uPVC double glazed window to front. Electric storage heater.

Kitchen

10'2" x 6'3"

Range of fitted wall and base units with roll top work surfaces. Stainless steel single drainer sink unit with tiled splash backs. Built in oven and hob with extractor over. Spaces for washing machine and fridge freezer. Extractor fan. Window to rear.

Bedroom One

12'5" x 9'6"

Window to front.

Bathroom

6'5" x 5'7"

Panel enclosed bath with electric shower over. Pedestal wash hand basin. Low level WC. Tiled splash backs. Extractor fan. Obscure glazed window to rear.

Exterior

Communal gardens and parking.

We routinely refer potential purchasers to Move with Us Ltd. It is your decision whether you choose to deal with Move with Us Ltd. In making that decision, you should know that we receive an annual payment benefits from Move with Us Ltd, equating to approximately £314.48 per referral.



DAGENHAM SALES | STEPS ESTATE AGENTS, 298 HEATHWAY, DAGENHAM, ESSEX, RM10 8LU

GROUND FLOOR

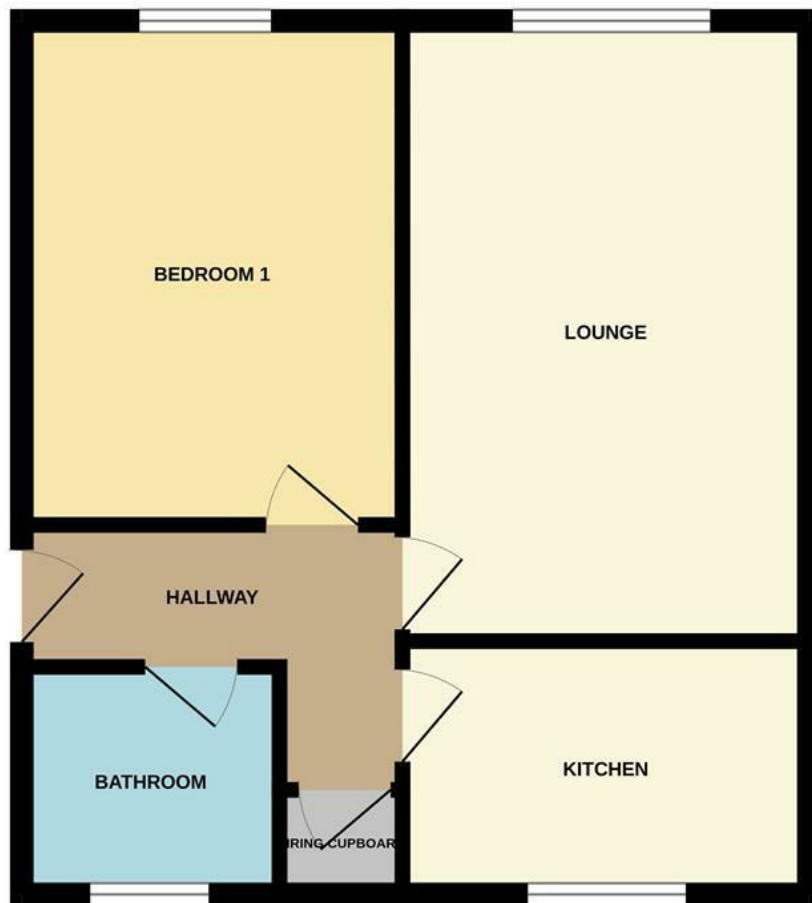

Call us on

020 8593 5933

dagenham@steps.me.uk

www.steps.me.uk

Council Tax Band

B

Energy Efficiency Rating		Current	Potential
Very energy efficient - lower running costs			
(92 plus) A			
(81-91) B			
(69-80) C			
(55-68) D			
(39-54) E			
(21-38) F			
(1-20) G			
Not energy efficient - higher running costs			
England & Wales		EU Directive 2002/91/EC	

Agents Note: Whilst every care has been taken to prepare these particulars, they are for guidance purposes only. All measurements are approximate and are for general guidance purposes only and whilst every care has been taken to ensure their accuracy, they should not be relied upon and potential buyers are advised to recheck the measurements.

Whilst every attempt has been made to ensure the accuracy of the floorplan contained here, measurements of doors, windows, rooms and any other items are approximate and no responsibility is taken for any error, omission or mis-statement. This plan is for illustrative purposes only and should be used as such by any prospective purchaser. The services, systems and appliances shown have not been tested and no guarantee as to their operability or efficiency can be given.
Made with Metropix ©2025

